



Sindhorn
Kempinski Hotel

BANGKOK

Sustainability Meets Luxury for Every Visit

November 2024



Sindhorn Kempinski The Nexus of Sustainability and Style

Thailand has a history and culture steeped in artistry and innovation, benefiting from the bounties of its natural surroundings while advancing into a well-developed society on the global stage. Since its foundation as Siam in 1350, visitors from near and far marvelled at the Kingdom's harmonious balance with the environment. Thriving farmers and traders extended waterways into canal systems, creating linkages to international markets. Merchants and artisans crafted comely yet practical products from coconut trees, banana leaves, and bamboo. Architects and designers transformed colourful pieces of broken pottery into brilliant structures like the Temple of Dawn.

And not long after Krungthep Mahanakhorn, or Bangkok, the Kingdom's crowning glory and capital city was founded, so too was another gem formed into being, Kempinski, Europe's oldest luxury hotel brand. Over the years, both have developed and thrived with a dedication and respect to heritage in all its aspects. So, it was only natural for the two to synthesize into the Sindhorn Kempinski. Sindhorn Kempinski is a luxury sanctuary blending Thai heritage and Kempinski style, with a deep understanding of the importance of sustainability for a long, prosperous, and serene future.

Sindhorn Kempinski is rooted in Thailand

Long before Sindhorn Kempinski Hotel Bangkok broke ground, three magnificent trees held court over the area between Tonson and Langsuan now known as Sindhorn Village. For over 100 years, these freshwater mangrove trees grew and flourished along with its environs. Sustaining its neighbours, from the flora and fauna to the burgeoning human developments, this trio provided shade and cleansing air as Bangkok grew into a bustling metropolis around it. Yet, they maintained their positions as nature's stalwarts, treasured as the neighbourhood's guardians, even as technology and concrete advanced. Sindhorn Kempinski's architects recognised these immeasurable treasures and ensured they maintained their cherished places, designing the grounds so that they could be replanted and continue to thrive, enriching the Chevaa Garden and all the surroundings.

These three guardians create a deep-rooted link from the Sindhorn Kempinski to the networks of gardens and parks flourishing throughout Bangkok. Visitors can wander from the Chevaa Garden surrounded by the verdancy of tree-lined Ton Son to Lumpini Park, Bangkok's first public park that is almost 100 years old. Envisioned as a World's Fair type location to showcase Thai culture and innovation, this 40-acre royal parkland was gifted to the people in 1925 and is still a haven for city dwellers seeking a natural reprieve. Nature's escape continues as a skywalk links Sindhorn Kempinski through Lumpini Park to Benjakitti Forest Park, cultivated from reclaimed industrial space into a vast space blossoming with flora, nourishing the city with its greenery and abundance.







Architecture and design blends modern design with nature

Sindhorn Kempinski boasts a design that melds with the gardens, undulating as if flowing with the sway of surrounding leaves and branches. The muted brown exteriors further blend the building into the environment, leading to an expansive lobby filled with natural lighting from almost every angle. Inventive engineer allows for air and light to flow up and through the building, making the most of nature's energy to save on lighting and air conditioning while creating a sublime atmosphere at every level.

The architects continued with their attentiveness to resources and sustainable design with such touches as tripled-layer glass that not only offers beautiful wall-to-ceiling views, but also insulates the building from noise and heat. This allows for energy savings while creating sound-proof accommodations for further guest comfort. All these innovative design details and practices have culminated in international recognition and global certification by LEED and EarthCheck, confirming our sustainability vision.

Detailed attention to reduce, reuse, and recycle

Guests can fully enjoy the luxuries in every room and suite knowing that every possible effort in sustainability has been integrated, including resource-saving fixtures, LED lighting, and eco-friendly paper water cartons and straws. Those who wish to actively contribute to environmental conservation can participate in our Green Artifact program, opting out of daily linen or towel replacements.

Our sustainability practices extend to every corner of our operations. Back-office operations reuse and economise paper and stationery as standard procedure and participates in the

SCGP paper and plastic recycling programme. Every restaurant and food outlet avoids single-use plastics and sources free-range eggs and chicken as well as locally grown, organic produce for their ingredients. This includes showcasing Bokaew and Baan Khunmaeruum coffee from Chiang Mai, 100% Arabica coffee cultivated and handpicked by the indigenous Pakakayo hill-tribe people. Sindhorn Kempinski also supports the local community through fund-raising and volunteering campaigns to aid those in need and to promote responsible practices.





Sustainability meets luxury for every visit

Sindhorn Kempinski Hotel Bangkok proudly stands as a world-class wellness resort that creates a sanctuary for mind and body in the centre of Bangkok, a thriving metropolis, while maintaining internationally recognised sustainable best practices. Every visitor can enjoy every luxury we have to offer knowing that every aspect has been curated and considered their pleasure as well as for its sustainability practice.

Thinking and acting locally and globally

Maintaining the highest standards in wellness hospitality while supporting sustainable practices means thinking and acting locally and globally. Sindhorn Kempinski believes we must execute initiatives within our community here in Bangkok and Thailand as well as participate in wider-ranging global programmes so that we can make a meaningful impact at home and around the world.

Every initiative acknowledges the importance of participating in a circular economy. We want to break from a linear economy, where we take a resource, refine it, use it, and then throw it away, even if we do not fully use that product. This practice can deplete resources to extinction while increasing pollution. A circular economy, on the other hand, is integral to sustainable practices, whereby by-products and waste are repurposed or upcycled so we can minimise the need for fresh resources.

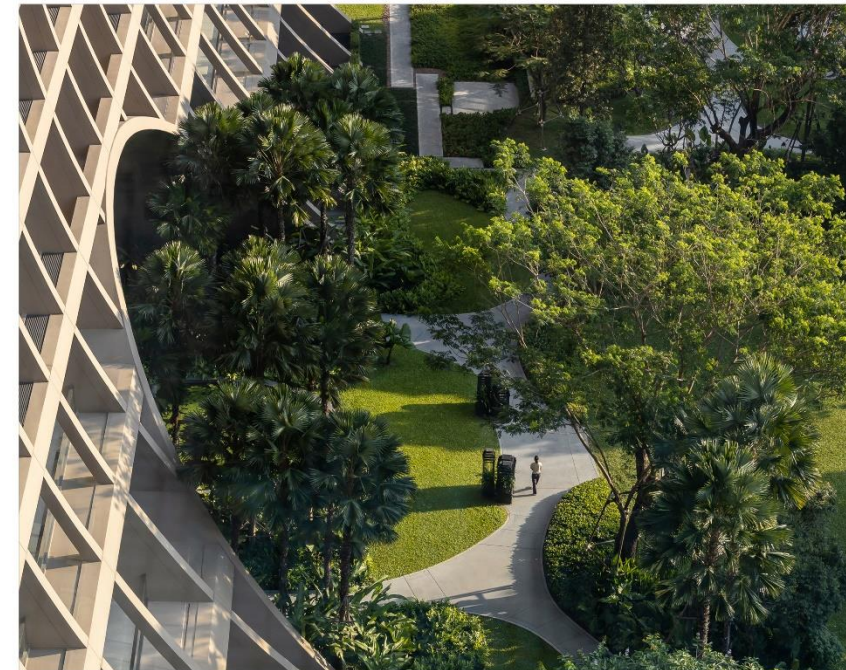



LOCAL ACTIONS FOR GLOBAL RESULTS

Sindhorn Kempinski Bangkok Hotel has a unique location in the centre of a cosmopolitan capital as its garden sanctuary, where thoughtful planning in landscaping, architecture, and engineering ensures that we blend and cultivate our lush green surroundings.



Creating beauty from organic waste

To nourish the flora that is the centrepiece of our luxurious serenity, we transform food waste, garden leavings, and other organic debris into nutrient-rich compost. The benefits are plentiful: biodegradable matter that would otherwise undergo anaerobic decomposition

into the greenhouse gas methane is repurposed as sustainable fertiliser, feeding our beautiful environment. Our composting initiative turns land-fill clogging garbage into verdant colourful gardens that visitors can enjoy up close and that helps clean our air near and far.

Reducing greenhouse gas emissions

Fundamental to keeping our guests in the lap of luxury and comfort is making sure that our rooms, suites, and facilities have ideal temperature control. The Sindhorn Kempinski was designed to optimise airflow throughout our open spaces, but our ventilation and air-conditioning systems require refrigerants to keep a cool environment. There are refrigerants

that contain ozone-depleting chemicals, but we choose products that do not, so we can lower the temperature without increasing global warming. Furthermore, we use clean, diesel-fuelled generators and equipment wherever possible as petrol produces more CO₂ per litre of fuel.

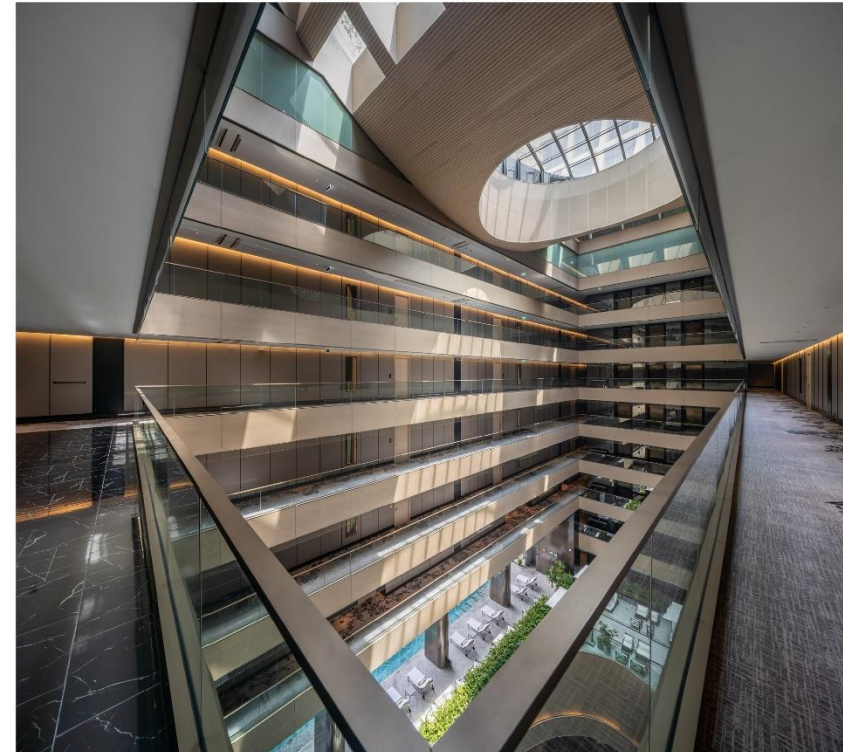



Turning Thailand's sunshine into power

Being near the equator with a tropical climate, Thailand is blessed with abundant sunshine. This makes Sindhorn Kempinski a lush escape for visitors around the world seeking Bangkok's bustle as well as a wellness sanctuary. Our location is also ideal for harnessing the sun's rays for solar energy, so we have installed solar panels on our rooftops that current produce

over 230 MWh annually. Solar panels are easy to maintain and help reduce carbon emissions. Also, we now have an independent source of energy, so we are less dependent on the national grid, reducing our utility expenses and contributing to the global shift to cleaner, greener energy source.

Not letting plastic go to waste

Around 350 million tonnes of plastic is thrown away every year globally, and in Thailand, it is two million tonnes. Unfortunately, only a fraction of that is recycled. Sindhorn Kempinski Hotel Bangkok is dedicated to reducing plastic use and recycling plastic more. We have phased out single-use plastics and try to use

more sustainable options wherever possible. And to deal with what plastic we still use, we have partnered with Corsair International Group. Plastic waste is collected for Corsair to pick up and use in their facilities that recycle the plastics into sustainable biofuel.







GLOBAL PROGRAMMES WITH LOCAL IMPACTS

As part of the Kempinski Hotels group, Sindhorn Kempinski Hotel Bangkok is proud to join our sister hotels and resorts in global sustainability campaigns and programmes that are making a positive difference in communities around the world. This includes three innovative initiatives with Diversey and two global sustainability certification schemes.



Soap for Hope™

Hygiene is an essential part of preventing pathogens from spreading and keeping a community healthy. Soap and water is a simple and extremely effective form of hygiene; however, there are communities around the world that do not have access to what many of us this are staples. Hotels like Sindhorn Kempinski provide fresh, new amenities such as

soap with each visit. We have to replace them for every new guest, so, rather than throwing away a perfectly useful soap remnant and create more waste, we participate in Soap for Hope™. Remnants are reprocessed through a resource-efficient, cold-press method to create new bars of soap that can then be distributed to communities in need.

Linens for Life™

Clean, comfortable sheets and spotless linens are among the iconic hallmarks of a luxury resort such as Sindhorn Kempinski. To maintain the highest standards, well-worn linens are not used. Nevertheless, they are still useful. Especially in the hands of Linens for Life™. With this programme, disadvantaged

communities, including refugees and those displaced by natural disasters, are trained to sew (using donated sewing machines). They can then upcycle the donated linens into products such as tote bags and articles of clothing that can be reused or sold for income.





Coffee Briques™

At Sindhorn Kempinski, guests can find a satisfyingly delicious cup of coffee at our many outlets, from Berthold Delikatessen, well as in their rooms and suites. While others may see coffee grounds as waste that may only be suitable for compost, Coffee Briques™ provide a novel solution from which many

communities can benefit. People learn how to process coffee grounds into fuel bricks that can be used for heating and cooking. This is an eco-friendly option to other fuels like charcoal, so it contributes to reducing deforestation, and communities can sell these bricks as an income source as well.

EarthCheck

Established in 1987, EarthCheck's scientific benchmarking programme has been a touchstone for the travel and hospitality industry. Sindhorn Kempinski confirmed our commitment to sustainable practices to delivery luxury experiences by being Silver Certified; one of over 40 Kempinski hotels around the world to achieve EarthCheck certification. We have proven that we can increase our

efficiencies while maximising guest experience and reducing overall environmental impacts. This includes reducing plastic use, such as opting for paper straws and tetra-packed water cartons; reusing and recycling paper, such as defaulting to double-sided printing; and sourcing organic and free-range products for all our food and beverage outlets.





VenueCheck

An extension of EarthCheck, VenueCheck provides EarthCheck members resources to ensure that their facilities, and the events held there, meet the same high standards of sustainability. Sindhorn Kempinski is dedicated to maintaining and exceeding sustainable

best practices, so we have implemented the VenueCheck sustainable management system so that all our events, whether in our stunning rooftop promenade, exquisite gardens, or spacious meeting rooms, are the height of elegance, style, and sustainability.

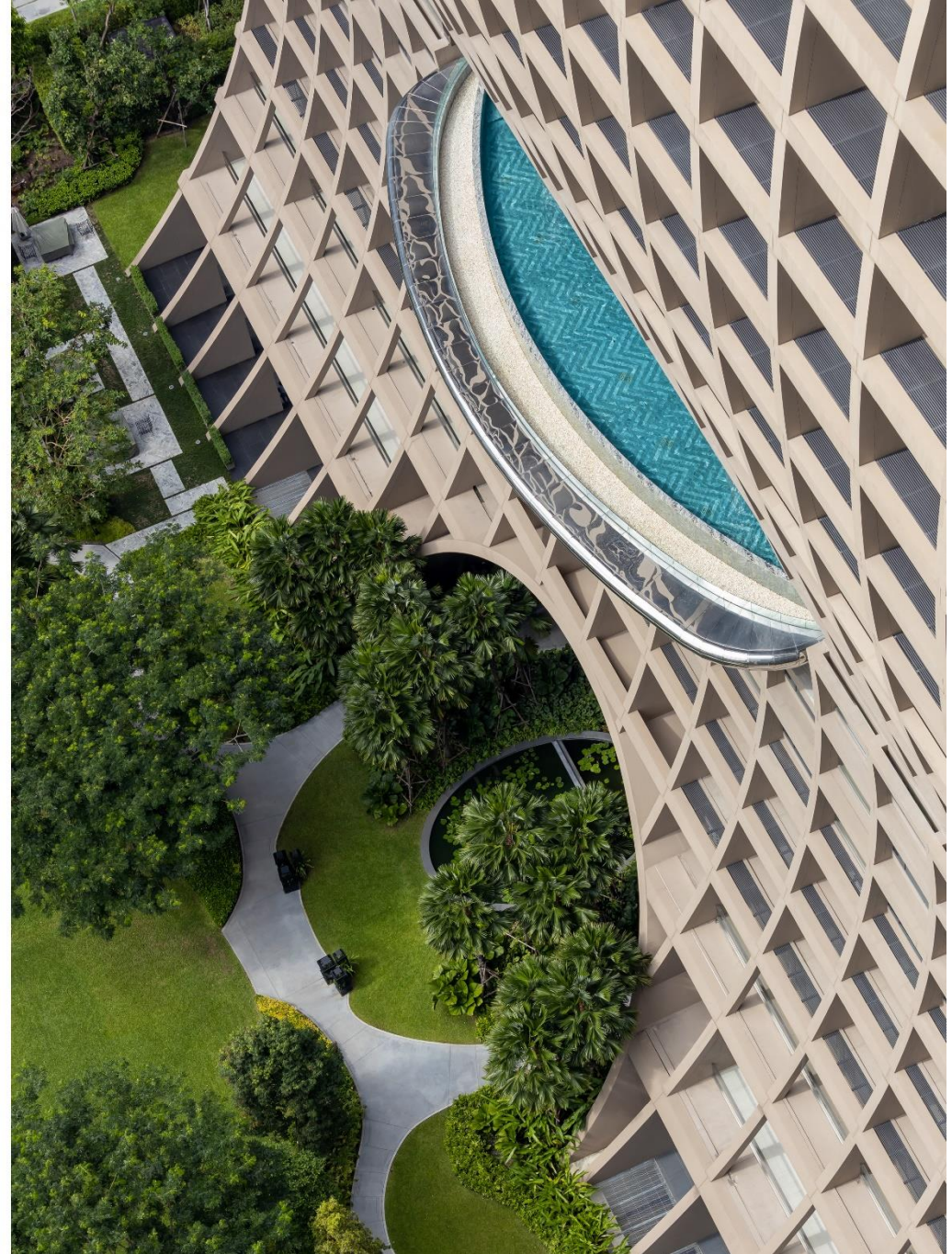



Sindhorn
Kempinski Hotel

BANGKOK

Thank You

Sindhorn Kempinski Hotel Bangkok
80 Soi Tonson, Lumphini, Pathumwan
Bangkok 10330 Thailand